

# 726SR Series Slide Door Closer



The Lockwood Rack & Pinion Slide Arm Series provides for a cleaner, more aesthetic appearance on the door whilst utilizing the same robust features and benefits of Rack and Pinion functionality.

## Specifications

<b>Power</b>	EN adjustable 2 to 6
<b>Back check (BC)</b>	Adjustable
<b>Hold Open</b>	Adjustable. Hold-open can be set at any angle up to 130° of opening.
<b>Handing</b>	Non-handed. Suitable for left or right hand doors
<b>Cover</b>	Clip-on
<b>Materials</b>	Extruded aluminium body manufactured from high-performance silicon alloy
<b>Mechanism</b>	Rack and pinion design
<b>Mounting</b>	Regular, parallel and over-door mounting
<b>Valves</b>	Adjustable closing and latching speed valves with overload protection

## Ordering Information

Model	Part Numbers	Finishes
<b>Slide Arm</b>	726SRSSS	Satin Stainless Steel
	726SRPSS	Polished Stainless Steel
	726SR SIL	Silver
	726SRGLD	Gold
	726SRBLK	Black

For formed cover with these finishes add:  
7726-171 (SSS,PSS,GLD) option  
726SR SIL + 726-171SSS = 726SRSSS

## Standards and Compliance



The Lockwood 726SR series closer has been successfully tested upto four hours (depending on type of doorset) on fire door assemblies in accordance with Australian Standard AS1905.1:2005, Part: Fire Resistant Door sets.

Note: Hold open option is not approved on any fire door.

**NOTE:** Slide Rail installation may result in a spring strength loss of up to 30% in most cases. Please consider the application and usage of the door prior to selecting the appropriate door control.

# 726SR Series Slide Door Closer

## 726SR Slide Arm Pull Side

### Part Numbers

726SR

Closer installed on pull side of door. This mounting position permits opening of 130°.

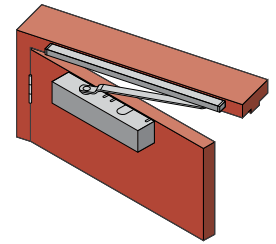
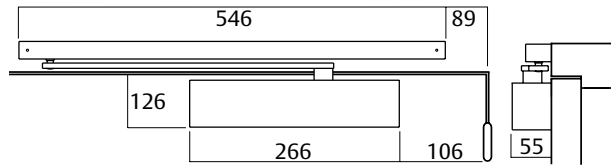

## 726SR Slide Arm Push Side

### Part Numbers

726SR

Closer installed on push side of door. This mounting position permits opening of 130°.

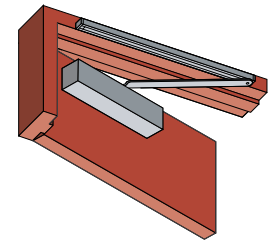
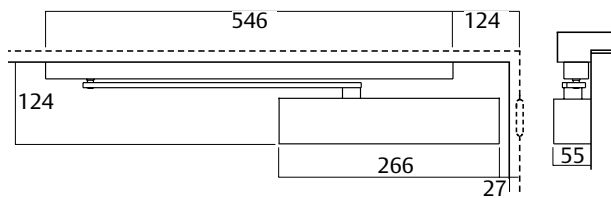

## 726SR Slide Arm Over Door Mounting Push Side

### Part Numbers

726SR

Closer installed on push side of door and top rail where conditions do not allow parallel mounting. This mounting position permits opening of 130°.

