

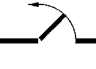

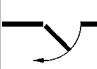

995 Narrow Style Multi Function Lock Installation Instructions

RIGHT HAND DOOR		LEFT HAND DOOR	
OPENING IN 	OPENING OUT 	OPENING IN 	OPENING OUT 
OUTSIDE	OUTSIDE	OUTSIDE	OUTSIDE

TO REVERSE BOLT

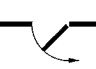
1. REMOVE FOREND
2. FOR EXTENDED BACKSETS REMOVE EXTENSION PACKER
3. PULL & ROTATE BOLT THROUGH 180° CLOCKWISE

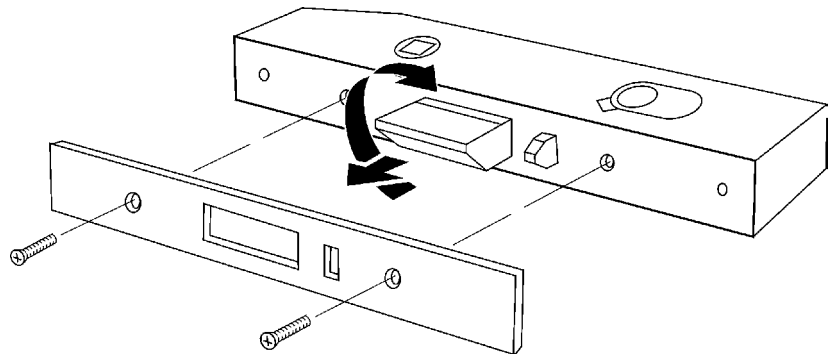

995 HANDING/FUNCTION ADJUSTMENT

V SERIES

HANDING ADJUSTMENT (Inside handle free)

To set for left hand

Push in and turn clockwise

Set adjuster as shown



Set adjuster as shown



To set for right hand

Push in and turn anti-clockwise

To set for C SERIES (Both handles lockable)

Set adjuster as shown



HANDING/FUNCTION ADJUSTER

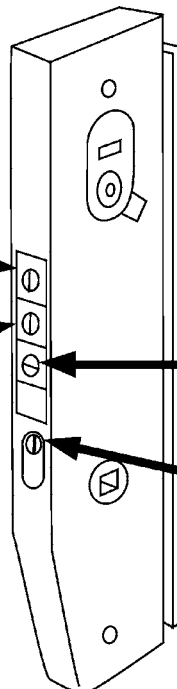

NOTE: ENSURE LOCKING BAR IS IN THE UNLOCKED POSITION.

IMPORTANT

A MAXIMUM CLEARANCE OF 5mm IS RECOMMENDED BETWEEN LOCK FOREND AND STRIKER PLATE FOR SECURITY REASONS.

995 LOCKS & LATCHES ARE DESIGNED FOR USE WITH SPRUNG DOOR FURNITURE. THE USE OF **UNSPRUNG** DOOR FURNITURE IS NOT RECOMMENDED.

Metal Door Preparation

1. Establish required height of the lockset on the door
2. Cut window for forend 156mm x 25.4mm with a 3mm radii
3. Place template in opening. Drill 4.5mm diameter holes with a countersink of 7.2mm diameter x 90°.
4. Drill appropriate holes for the selected lockset.

23mm Backset Illustrated.

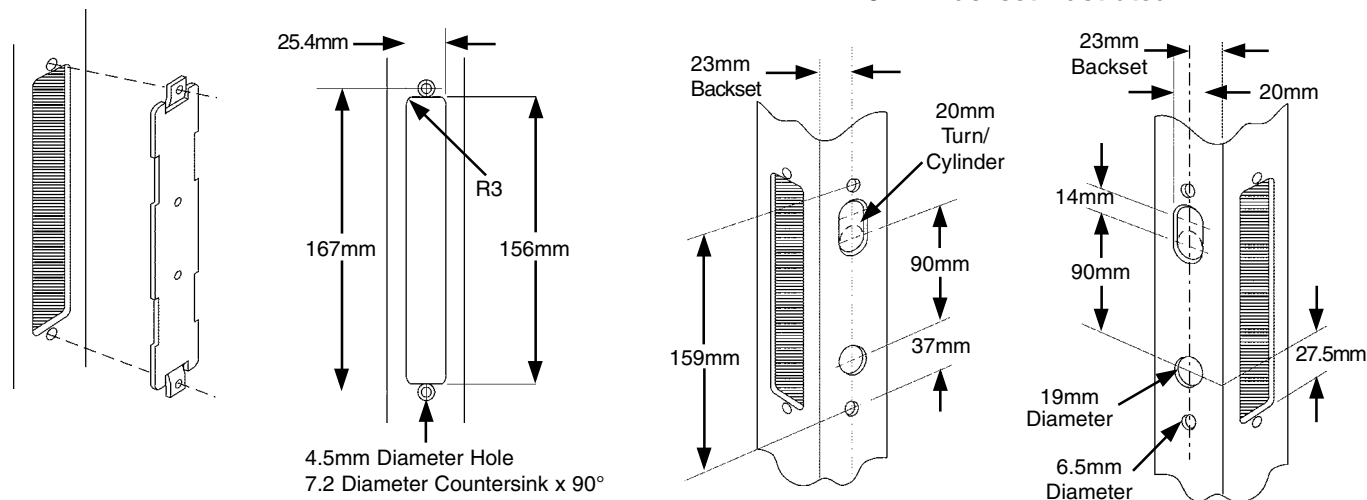

Wooden Door Preparation

1. Establish required height of lockset on the door.
2. Cut mortice slot, using template for the appropriate backset.
3. Fit lock into mortice, scribe around forend and remove wood to allow flush fit to door.
4. Remove lock and use template to mark and drill holes to suit lock and furniture being used.

NOTE:

DO NOT DRILL HOLES RIGHT THROUGH DOOR. THE FURNITURE MAY NOT COVER ANY HOLES THAT ARE INCORRECTLY DRILLED.

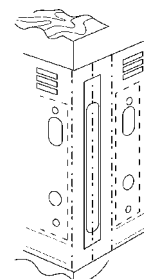

Turn Adapter

1. Remove retaining screw from the side that the adapter is to be fitted.
2. Insert adapter and secure with retaining screw.

NOTE:

TURN ADAPTER ROTOR IS REQUIRED TO BE ENGAGED IN THE YOKE OF THE LOCKING BAR

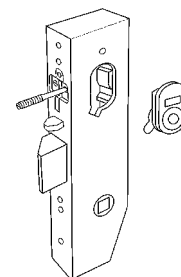

Install Lock

1. Insert lock into door and secure
2. If cylinders are required to be fitted, remove retaining screw from the side that the cylinder is to be fitted.
3. Insert cylinder and secure with retaining screw.
4. Secure forend.

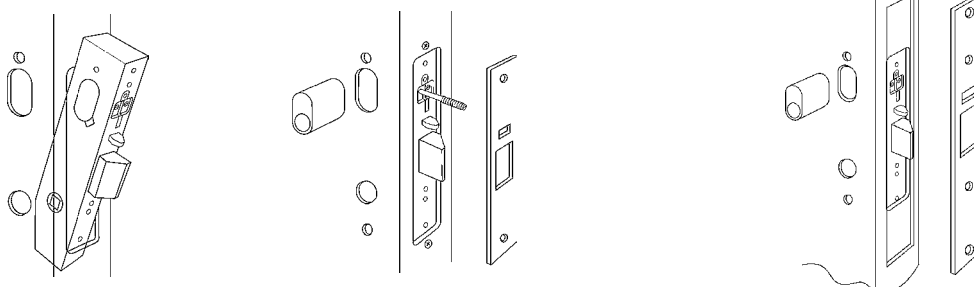

Install Strike

METAL DOORS

1. Prepare door jamb cutout.
2. Fit strike box to frame.
3. Fit strike to strike box.

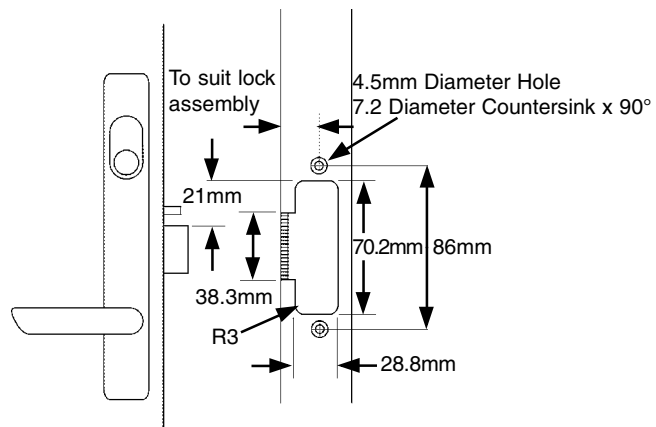

WOODEN DOORS

1. Mark door frame for strike.
2. Remove wood so strike sits flush with frame.
3. Mortice 15mm deep recess for bolt.
4. Optional - Mortice out for plastic strike box.
5. Secure strike to frame.

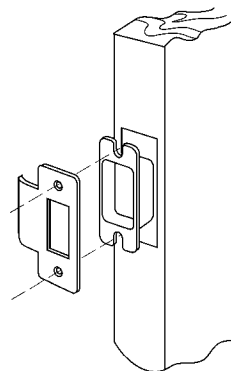

23mm Backset

30mm Backset

38mm Backset

6.5mm DIAMETER

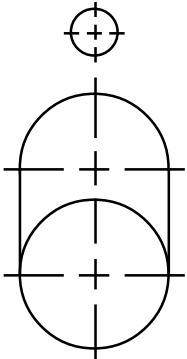

20mm DIAMETER
*ONE HOLE
FOR TURN
TWO HOLES
FOR CYLINDER*

SPINDLE HOLE
20mm DIAMETER

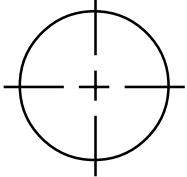

6.5mm DIAMETER



MORTICE
CENTRELINE

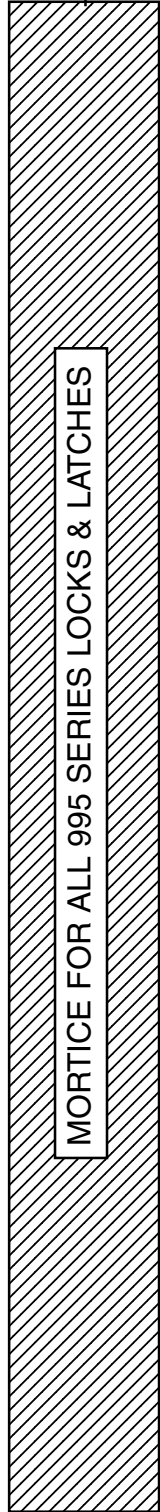

MORTICE FOR ALL 995 SERIES LOCKS & LATCHES

200mm

20mm

23mm Backset

30mm Backset

38mm Backset

6.5mm DIAMETER

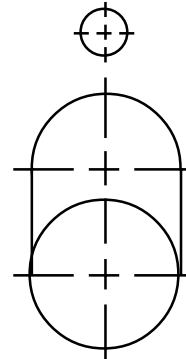

20mm DIAMETER
*ONE HOLE
FOR TURN
TWO HOLES
FOR CYLINDER*

SPINDLE HOLE
20mm DIAMETER

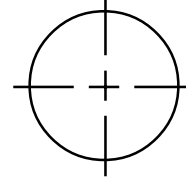

6.5mm DIAMETER



MORTICE DEPTHS

23mm Backset = 44mm
 30mm Backset = 51mm
 38mm Backset = 59mm