

LEICHHARDT SLIDING SECURITY SCREEN DOOR LOCK

FITTING INSTRUCTIONS

1. Cut out door section to dimensions shown below on both sides of door stile.

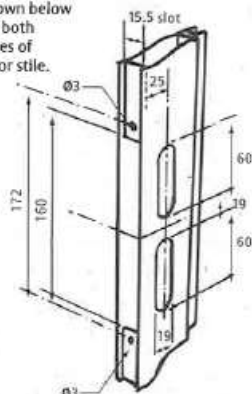

2. With lock body in un-locked position, insert into cutout. Secure with two 12mm countersunk self tapping screws supplied

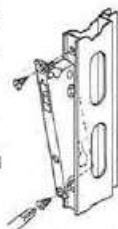

- 3(a). Select 'handle' that will be used internally, fit operating and snib levers, ensuring correct orientation.

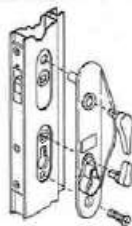

- 3(b). Fit plastic snib plug to external handle, it is important that this is fitted securely.

Fit 'handles' to lock ensuring that the snib lever is in an upright position. Secure but do not tighten with two 18mm countersunk thread forming screws supplied.

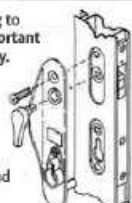

- 3(c). To allow fitment of lock cylinder, lock the mechanism using the snib lever. Position the cylinder lock in the lock body so the cam turns towards the front end of the door. Secure with 32mm countersunk metal thread screw supplied.

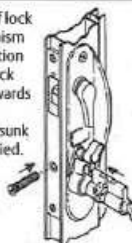

- Important: Over tightening this screw may jam locking mechanism.

4. Operate lock by unlocking with key first and then by using snib. Ensure free operation. Secure all screws. (Do 'not' over tighten handle securing screws).



5. Ensure lock body is in an unlocked position. Position latch striker into lock body.

Partially close the door and mark position of striker on outside of jamb.

Remove striker from lock body. Drill two 3mm dia. holes and fit to door jamb where marked using 12mm countersink screws supplied.

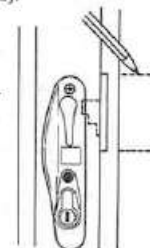

- Note: If required 2mm or 4mm packers are available as optional extras.

Important:

1. The snib lever is 'not' a security device. It is to be used as a temporary measure only. For full security the door should be 'key locked'.

2. A feature of this lock is that it can not be locked until it is fully latched to the striker (i.e. it can not be locked while the door is ajar thus avoiding damaging the lock by slamming in a locked position).

3. The Whitco warranty will not apply where a fault is due to the use of a non-genuine Whitco cylinder with this product.

4. When removing key after locking, it is important that key is not turned past the vertical position. Failure to adhere to this could result in unlocking of the locking cylinder.

SAFE AND SECURE

For safety reasons, when the premises are occupied, it is recommended that the handle be snib locked or left unlocked. If this is not possible or desirable, leave the key in close proximity where all members of the family have access to it in case of a fire or an emergency.